



# Pura

professional  
dishwashers



For more than 40 years, Smeg Professional has been dedicated to producing premium high-performance appliances for the commercial sector. With three production sites and specialised testing laboratories, the division ensures top quality and innovation. Smeg Professional serves a global market through an extensive worldwide sales and service network, meeting the needs of sectors ranging from hospitality to healthcare while prioritising efficiency and sustainability.

## The Range

# Performance meets versatility

### PURA Undercounter Glasswasher 400×400



Designed for compact spaces, the 400×400 glasswasher fits under any counter and delivers sparkling glasses with every wash.

- SHR+ System (page 14)
- Built in reverse osmosis system (page 16)

### PURA Undercounter Glasswasher 500×500



Offering high productivity and excellent wash results, it fits under any counter without compromising space. Its exceptional performance delivers brilliantly clean glasses with each wash.

### PURA Undercounter Dishwasher 500×500



The 500×500 dishwasher range guarantees exceptional cleanliness and hygiene in every cycle. Compact, tough and reliable, they fit seamlessly into any space.

Available in Raised version for the maximum convenience.

### PURA Undercounter Traywasher 500×500



Designed for impeccable cleaning, offering a compact yet highly efficient solution for bakeries, butcheries, and pastry shops. Their powerful performance ensures thorough cleaning in every cycle, even for stubborn dirt. It works with 60×40 baking sheets.

Available in Raised version for the maximum convenience.

Smeg Professional offers a complete range of advanced dishwashers, from compact glasswashers to high-productivity hood type models, all built to the highest standards. Each model features a moulded tank and rack guides, full 304 steel construction, integral double skin, and a counterbalanced door.



PURA Hood Type 500×500

The hood type range is the ideal partner for achieving impeccable results, in any condition. Perfect for intensive applications, this range delivers high performance even under pressure.

- SHR+ System (page 14)



PURA Hood Type 600×500

The 600×500 hood range delivers exceptional wash capacity, making it ideal for efficiently managing large volumes of kitchenware. Designed for demanding environments, it maintains high performance even under pressure.

- SHR+ System (page 14)





The PURA dishwasher range is designed for fast-paced working environments, offering rapid wash cycles and exceptional cleaning performance. Built for heavy-duty use, PURA models handle large volumes of dishes efficiently, with intuitive controls and easy maintenance to ensure smooth, continuous operation.

## MyPersonal Wash

# Every dish deserves a tailored cycle

### Customisation of all parameters

---

This feature allows users to customise every wash parameter—time, temperatures, chemicals, pressure levels, and optional programs—creating a fully tailor-made wash cycle.

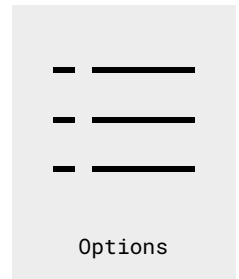
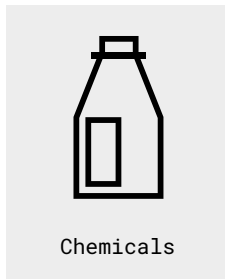
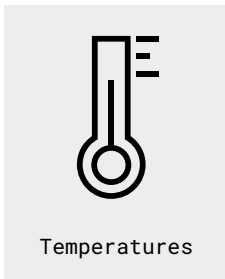

### Wash programs

---

Each machine comes with 10 preset wash programs, offering a complete, ready-to-use solution for a variety of washing needs. These programs are fully customisable, allowing to adjust wash parameters to match specific needs.

## Program visibility

---

Users can select which programs they want displayed, enhancing operational efficiency through a more streamlined, customised interface.

## Advanced interface

---

The touch display, with a user-friendly graphical interface, makes managing all functions simple, fast, and intuitive. It acts as the “enabler” of the MyPersonal Wash feature.



## Precision Washing System

# Power and accuracy in every drop

This innovative wash system redefines cleanliness, delivering exceptional standards by merging power with precision in every cycle, without compromise. Setting a new benchmark in cleaning with a system designed to impress in every detail. Each cycle is engineered for uncompromising

performance, consistently maintaining optimal wash times, pressure levels, and resource efficiency—even after repeated cycles. This advanced system not only enhances the thoroughness and reliability of each wash but also minimises water, energy, and chemical usage, providing a powerful and sustainable solution.

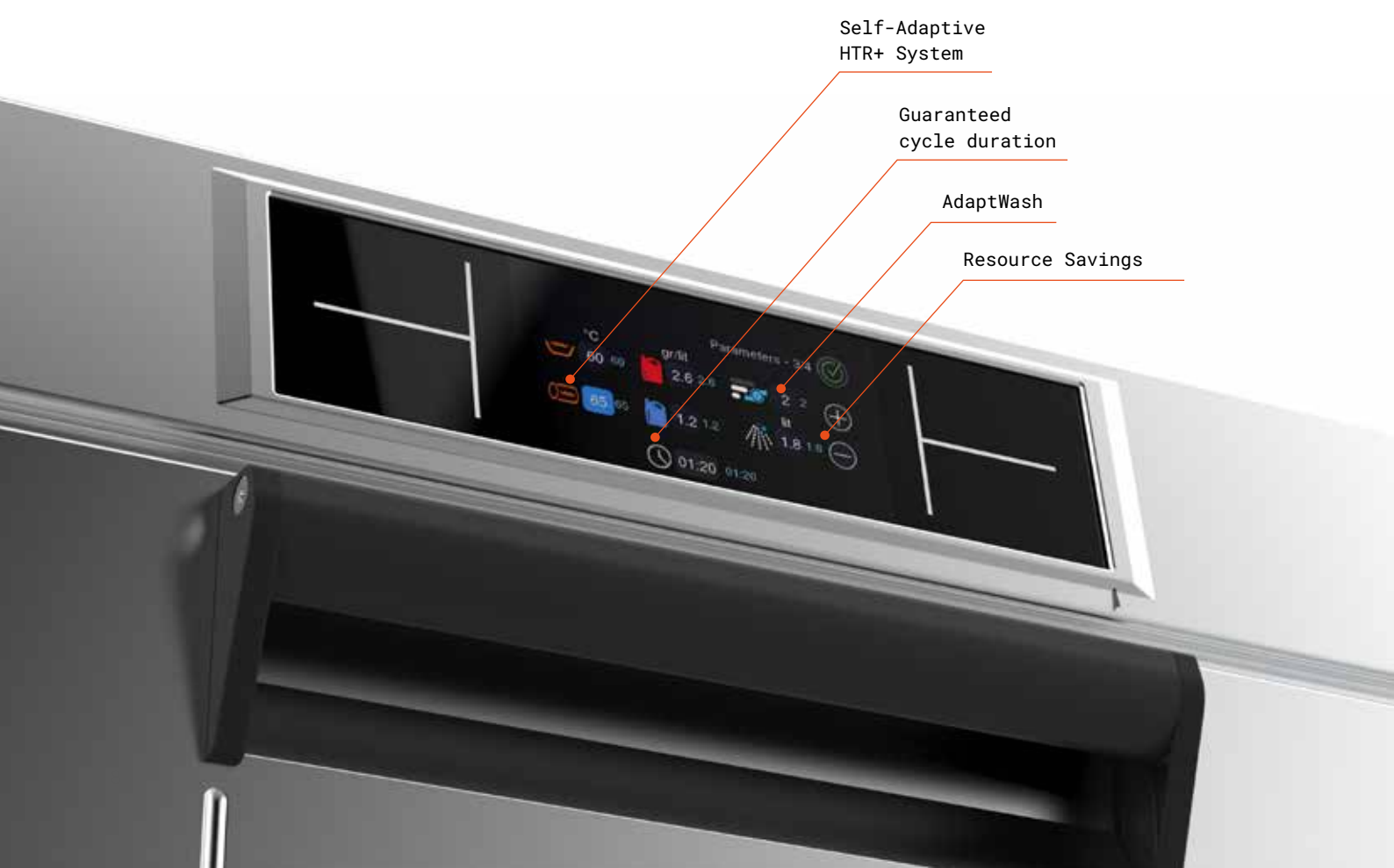

Self-Adaptive  
HTR+ System

Guaranteed  
cycle duration

AdaptWash

Resource Savings

## Guaranteed cycle duration, every time

---

# +20%

productivity on repeated cycle

PURA dishwashers deliver consistent performance with every wash, ensuring that each cycle maintains the same precise duration and temperature, cycle after cycle. Thanks to recent advancements, productivity has increased by 20% on repeated cycles compared to earlier models. This innovation ensures steady output, delivering uniform results under consistent conditions, no matter the frequency or load size. For businesses prioritising efficiency and quality, this dependability streamlines operations while delivering exceptional cleaning results.

## Resource savings

---

PURA dishwashers deliver significant resource savings, including reduced water usage. The rinse volume is lowered from 3.2L up to 1.8L with an average rinse value across all platforms of 2L. In addition to the reduction in water consumption, there is also a decrease in the use of chemicals.



3.2L

Previous water consumption.

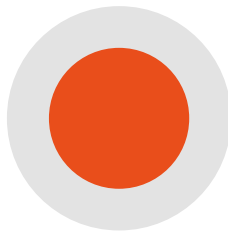

2L

Water consumption across all platforms.

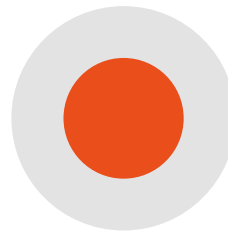

1.8L

Water consumption with Eco Cycles and Crockery Express Programs.

## AdaptWash

The AdaptWash system features three pressure levels that automatically adjust to the selected program, delivering optimal cleaning for every type of load. Level 1 is perfect for light soil and delicate items, Level 2 handles moderate dirt, and Level 3 is built to power through tough stains. With these three distinct settings, the system guarantees precise and efficient wash performance.

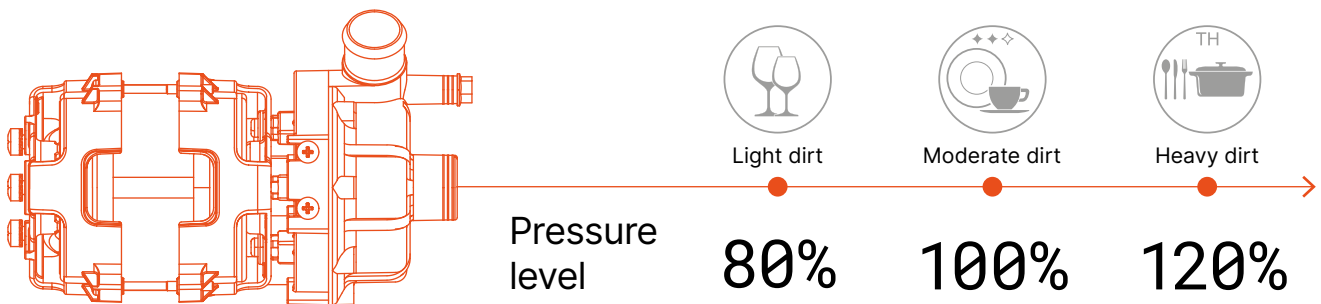

## Self-Adaptive HTR+ System

The HTR+ System, combined with the atmospheric boiler and Thermostop, prevents cold inlet water from entering during rinsing, maintaining temperatures up to 87°C.

The Self-Adaptive HTR+ System adjusts water volume for each load, while intelligent rinse management ensures consistent, reliable performance for even, precise results every time.

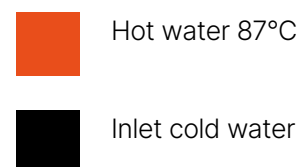
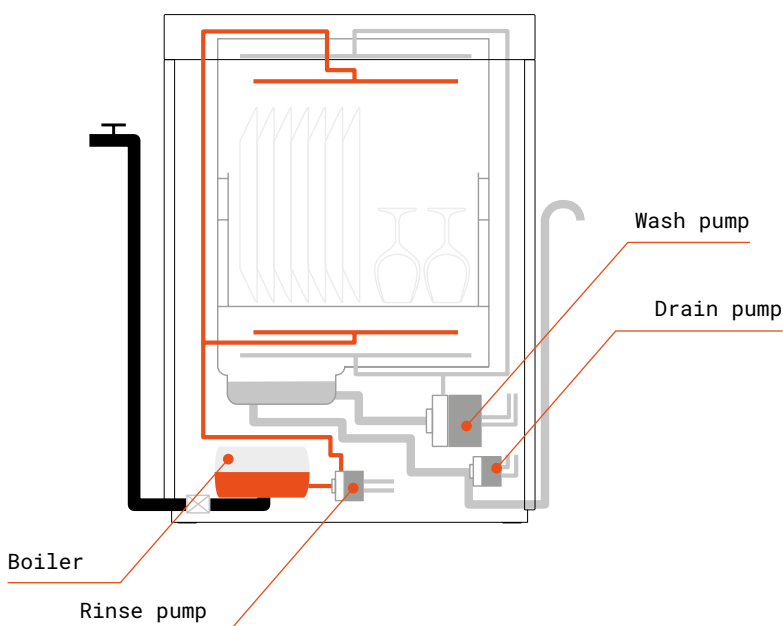



## Patented 5-stage Filtration System

# Revealing perfection in every detail, even the unseen

### Filter-enhanced wash for spotless results

The advanced filtration system eliminates impurities, delivering a flawless wash that protects your dishware's quality. Each cycle ensures spotless results with the purest possible wash action, treating your dishes with exceptional care.

### Faster water exchange

The compact tank design enables faster water exchange, fully replacing water every 4.4 washes for undercounter models and every 5.6 washes for hood-type models. This ensures consistently fresh water and superior cleaning performance with every cycle.

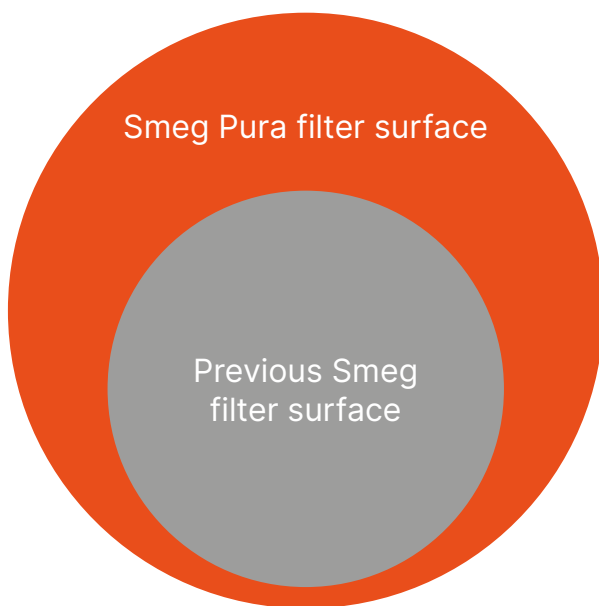

# 45%

Larger surface area to prevent debris buildup and protect the pumps from mechanical damage.

### Filter control sensor

PURA dishwashers feature a sophisticated Filter presence control that monitors the right positioning of the filtration system. It alerts when the filter is not in the correct position, and ensures perfect results and prevents any damage to the system.

Stage 1

2 mm pre-filter  
to capture the most  
coarse soil.

Stage 2

Ø0.89 mm micro-filter.  
The finest soil is  
captured at this  
filtration stage.

Stage 3

Ø0.51 mm micro-filter.  
An additional step to  
capture fine soil.

Stage 4

Ø2 mm filter grid.  
Pre-filter grid to retain  
soil from the tank and  
maintain clean water.

Stage 5

The final stage  
protects the wash  
and drain pumps  
from foreign objects  
accidentally dropped  
into the tank during  
filter maintenance.

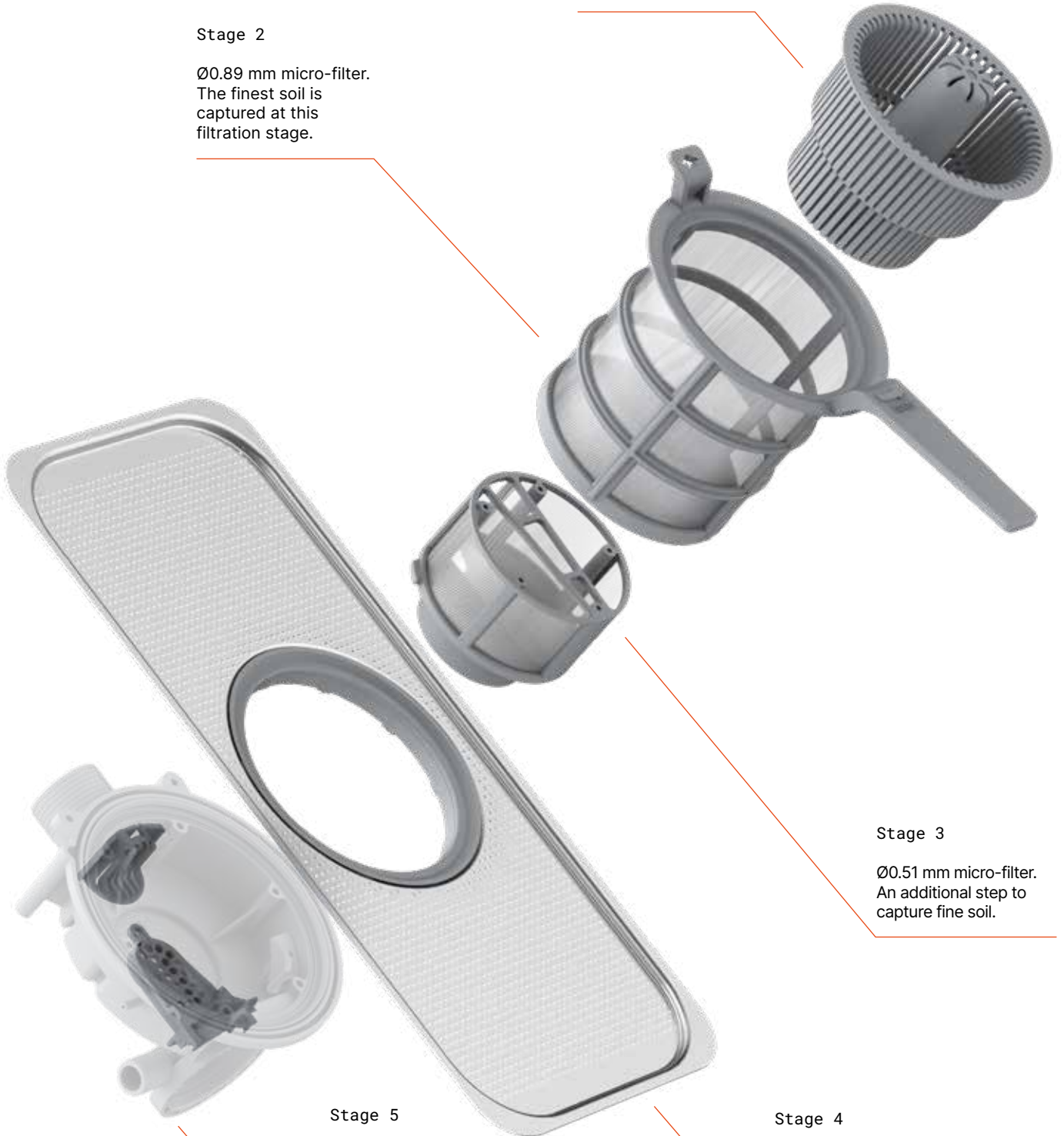

## Steam Heat Recovery System (SHR+)

# Energy efficiency and optimal comfort

The SHR+ steam heat recovery system plays a vital dual role in efficient steam management, offering three key benefits:

### Compact Space

The system eliminates the need for an additional hood for steam extraction, ensuring a more compact setup without compromising performance.

### Air Purity

The SHR+ system is designed to eliminate steam during operation, improving air quality by preventing humidity buildup and condensation in the workspace. This not only ensures a healthier environment for staff but also reduces the risk of mold and mildew growth, creating a safer, more comfortable workplace.

**+25%**  
energy savings

### Energy Savings

The SHR+ system recovers 100% of the energy of the steam and provides significant savings in both energy consumption (up to 25%) and operational costs, as it operates independently without the need for costly external systems.

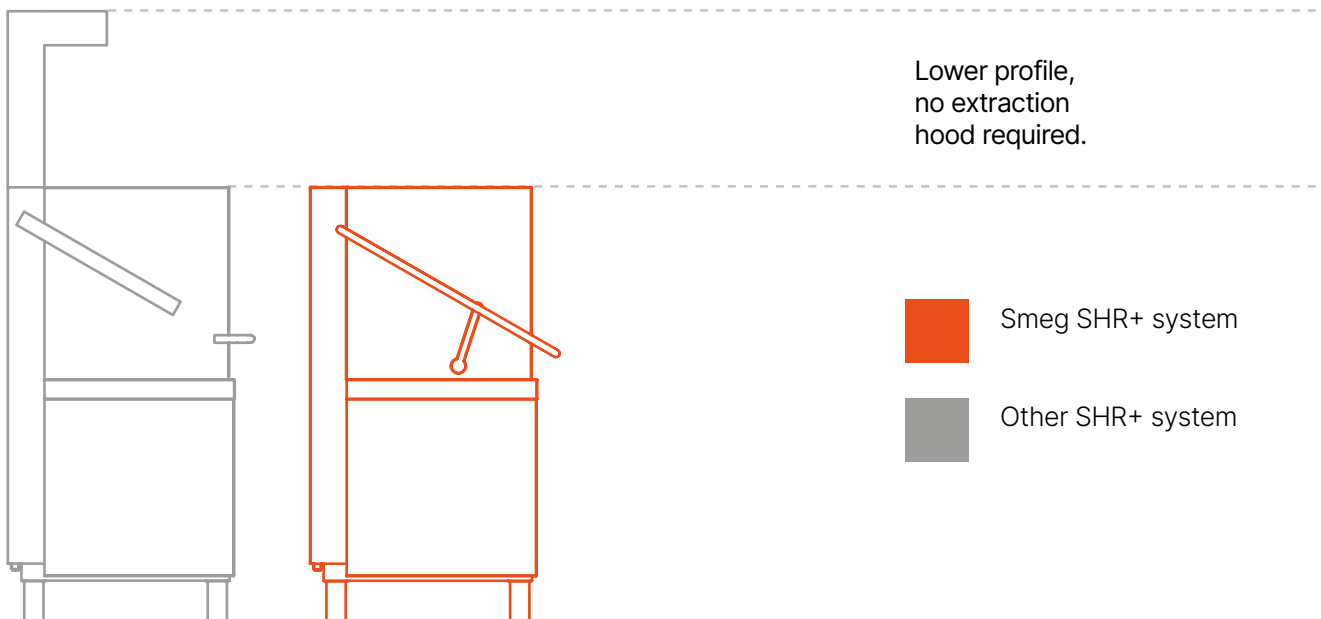

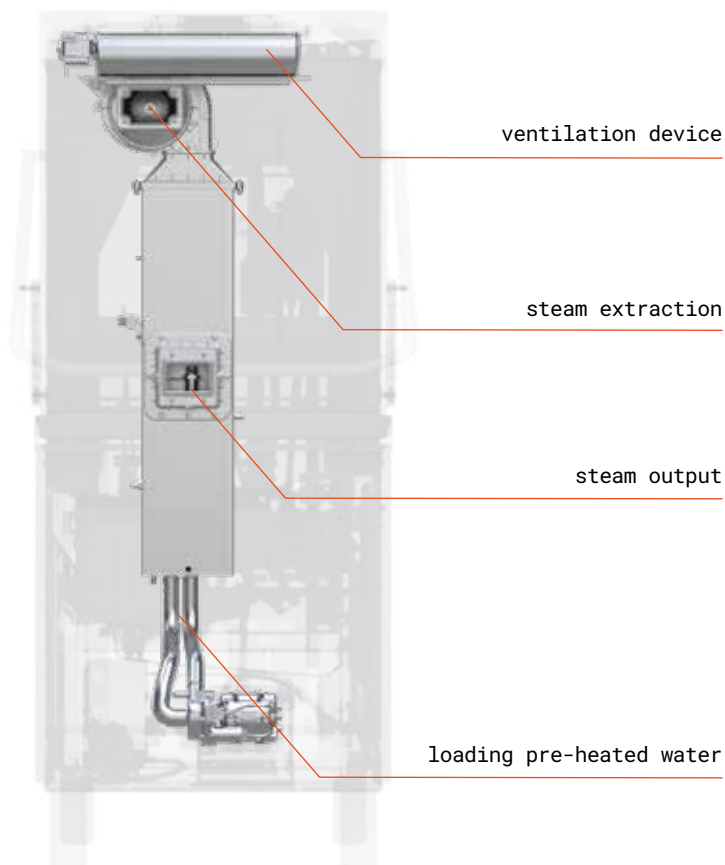
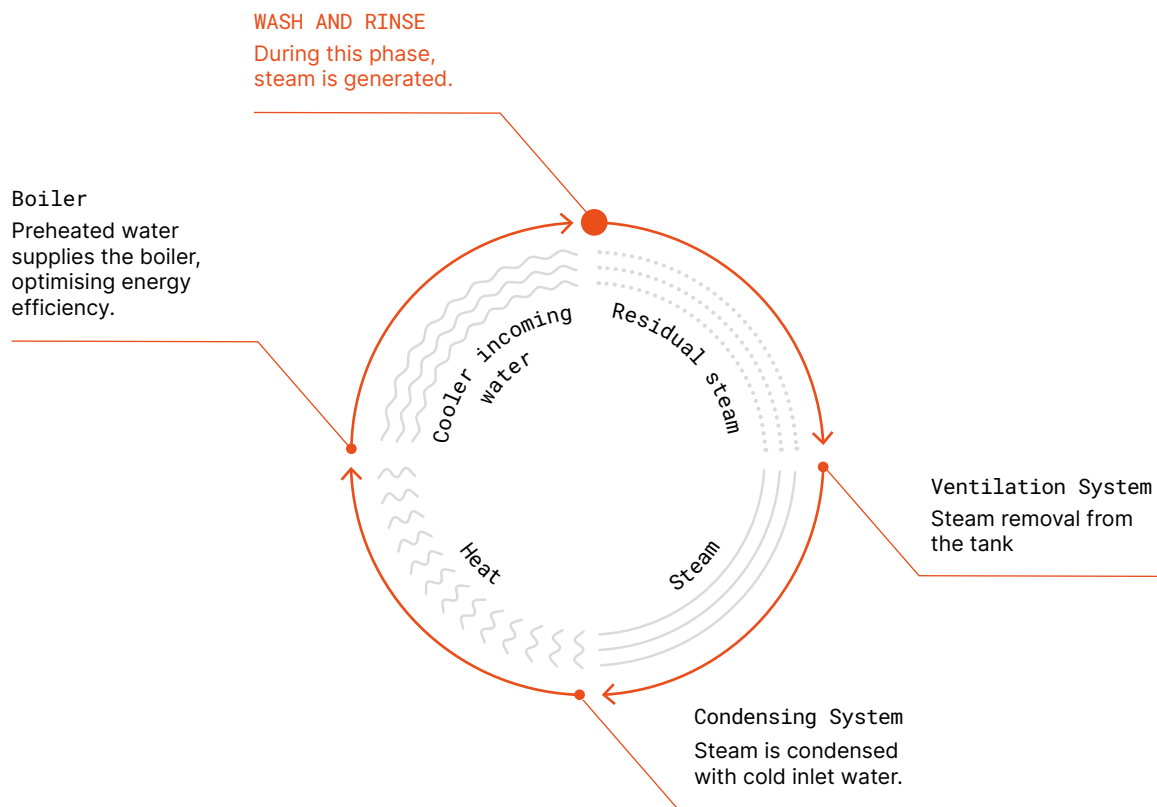

### SHR+ system for Undercounter

Undercounter dishwashers use cold water to condense steam from wash and rinse cycles. The heated water is recirculated to the boiler, reducing energy consumption while enhancing efficiency.

### SHR+ system for Hood Type

A rear air blade prevents steam escape, while the SHR+ system captures and condenses rinse steam, using its energy to preheat incoming water for greater efficiency.

## Integrated Reverse Osmosis System Brilliant results with every wash

The integrated Reverse Osmosis system in the 400×400 mm Glasswasher ensures high water quality, delivering spotless, ready-to-use glasses without the need for manual drying. The treated water, enhances detergent and rinse aid effectiveness and eliminates scale buildup.

Pre-installed and housed on a removable, durable platform, the system simplifies setup and provides easy access for maintenance. Even when the system is removed for servicing, the glasswasher continues to operate without any interruption to service.

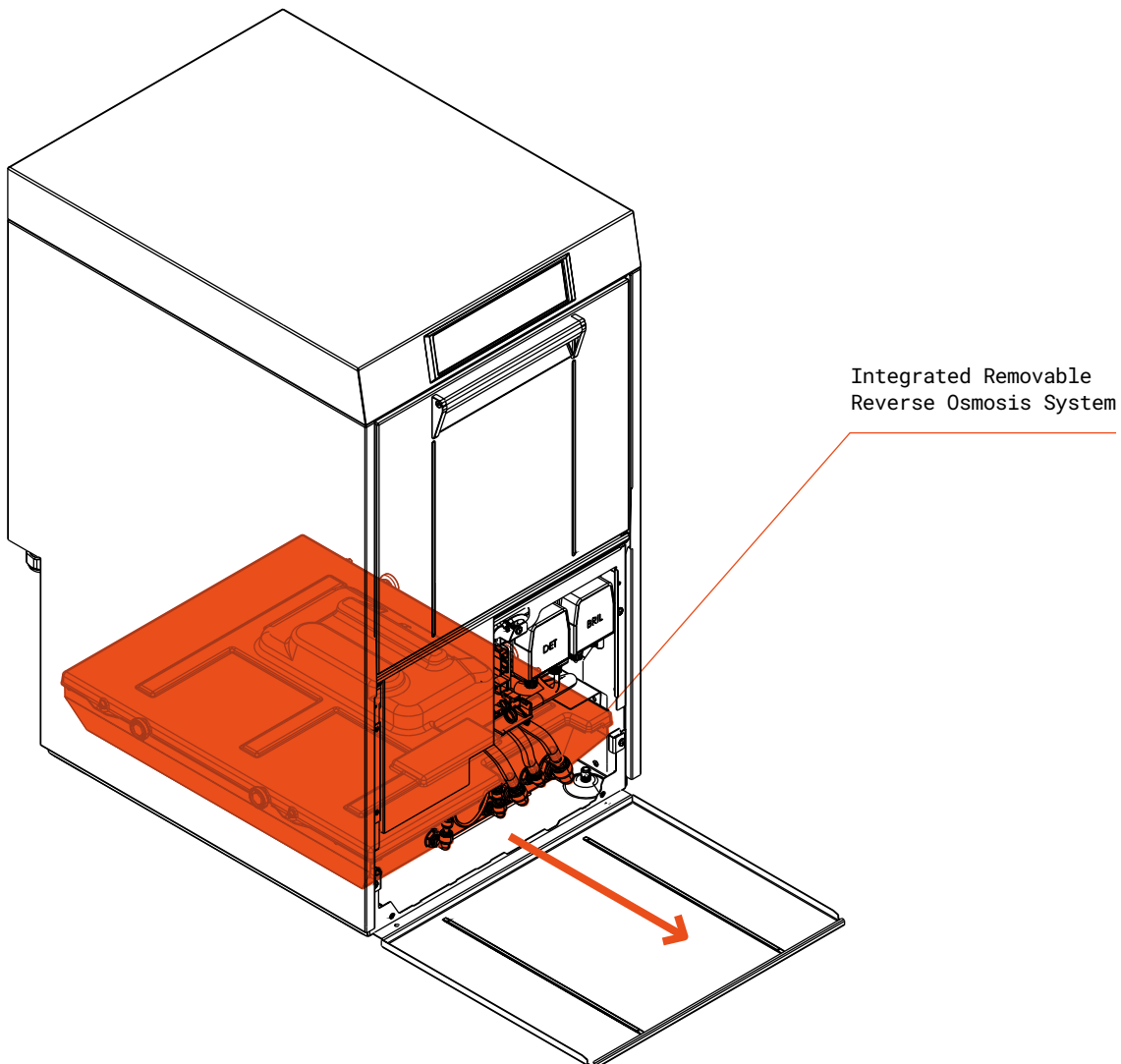

## Twin baskets

# Twice the capacity, maximise your savings

The PURA range features models with twin baskets, one of which is fully removable, offering enhanced load capacity and flexibility in arranging items.

These twin basket models are also an eco-friendly choice, as they allow for larger loads, reducing the number of wash cycles needed and, in turn, lowering energy consumption and chemical usage.



Three different configurations are available to suit various needs.

01



Plates (max Ø225 mm)  
Cups (max H 110 mm)

02



Plates (max Ø145 mm)  
Glasses (max H 190 mm)

03

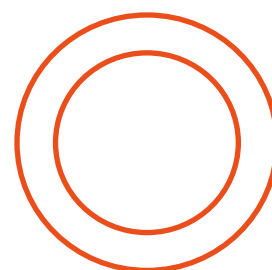

Plates (max H 415 mm)



PURA glasswashers are the ideal undercounter solution for wine and cocktail bars requiring continuous, high-quality cleaning. Compact and efficient, they deliver rapid cycles to keep up with peak service times, ensuring glasses are spotless, dry and ready for use. Designed for precision cleaning, they handle everything from delicate wine glasses to sturdy tumblers, combining speed, reliability, and user-friendly operation.



## Sustainability

# Designing the future with responsibility and innovation

### SHR + Steam Heat Recovery system

The SHR+ system extracts all residual steam after the rinse cycle to preheat incoming water, resulting in significant energy savings. Additionally, the system is designed to remove excess steam when the hood is opened, helping to maintain a cleaner and healthier working environment by improving air quality. This innovative approach reduces energy consumption while enhancing the overall working atmosphere, making the SHR+ system an eco-friendly choice for professional dishwashing.

### Integral Double Skin

The Integral Double Skin design provides exceptional insulation of the entire structure, significantly minimising heat loss and noise emission during operation. This feature also enhances energy efficiency by reducing the time and energy required to maintain optimal temperatures in the tank.

# 12%

Daily savings compared to dishwashers without stand-by system

### Stand-by system

The Stand-by system boosts energy efficiency by limiting the operation of the boiler and tank when the dishwasher is not in use. This feature offers up to a 12% energy saving, ensuring that resources are utilised only when needed.

At Smeg, sustainability is at the core of our commitment to developing appliances with a responsible and forward-thinking approach. We harmoniously integrate design and technology to offer a diverse range of durable products that embody our long-term vision for a more sustainable future.





## ECO Cycle

---



s Runtime	°C Wash	°C Rinse	lt Rinse	Lev Pump
80	60	65	1.8	2

The ECO Cycle offers a short wash duration that reduces the consumption of water, energy, and chemicals. By streamlining the wash process without compromising cleaning quality, this cycle supports sustainable practices in commercial kitchens.

## Reduced tank capacity

---

With a reduced tank capacity, PURA dishwashers optimise energy and water usage during the initial filling and temperature maintenance phases. This thoughtful design choice ensures that resources are conserved from the outset, leading to lower energy bills and a smaller environmental footprint.

## Packaging renovation

---

The new packaging has been fully redesigned to enhance sustainability and minimise environmental impact. All plastic materials have been removed, with polystyrene corners replaced by sturdy cardboard alternatives, offering the same level of protection. Additionally, 85% of the paper used in the packaging is made from recycled materials.

Smart Connectivity

# Optimise, monitor, and control anytime, anywhere

With the Touch Control Display, Wi-Fi connection and app, you're always connected to your dishwasher, giving you access to key operating parameters for intelligent, efficient wash management.



## SmegConnect PRO: smart control for superior efficiency

SmegConnect PRO provides real-time monitoring and management, delivering key insights on water, energy, and detergent usage. Access performance data remotely, customise settings for optimal efficiency, and receive instant alerts for maintenance to prevent downtime. Designed for high-demand environments, SmegConnect PRO ensures efficient, sustainable, and seamless dishwashing operations.



## Remote control

---

Easily select wash programs and start cycles from your device. Monitor cycles in real-time, including wash temperature, detergent and rinse-aid levels and pump pressures.

## Self-diagnostic

---

Receive instant alerts for any issues or errors, enabling faster service by identifying problem types and locations in advance.

## Performance analysis

---

Track your dishwasher's efficiency through the app, generating daily reports on cycles, energy consumption, and performance to optimise usage.

## Pura professional dishwashers

# Technical data

	Glasswasher 400x400	Glasswasher 500x500	Dishwasher 500x500	
Range	Undercounter	●	●	●
	Raised			●
	Twin Basket			●
	Softener	●	●	●
	Steam Heat Recovery System (SHR+)	●		
	Integrated Reverse Osmosis System	●		
General data	Basket dimensions	400x400 mm	500x500 mm	500x500 mm
	Net weight	46 Kg	56 Kg	61 Kg
	Usable load height	315 mm	300 mm	400 mm
	Tray capacity	-	-	7xGN 1/1 (530x325 mm)
	Rinse pump	Yes	Yes	Yes
	Drain pump	Yes	Yes	Yes
	Wash Programs	10 customisable programs	10 customisable programs	10 customisable programs
	Self-cleaning Programs	4	4	4
Technical data	Protection class	IPX4	IPX4	IPX4
	Noise	56 dB	56.5 dB	56.5 dB
	Maximum baskets/hour*	45	45	45
	Maximum dishes/hour*	360	810	810
	Maximum glasses/hour*	1125	1620	1620
	Wash temperature (min-max)	60-70°C	60-70°C	60-70°C
	Rinse temperature (min-max)	65-85°C	65-87°C	65-87°C
	Cold rinse temperature	24°C	24°C	24°C
	Tank capacity	7 L	11 L	11 L
	Minimum water consumption per cycle	1.8 L	1.8 L	1.8 L
	Inlet pressure (min-max)**	100-1000 kPa	100-1000 kPa	100-1000 kPa
	Inlet water temperature (min-max)***	5-60°C	5-60°C	5-60°C
	Tank power	2.0 kW	2.0 kW	2.0 kW
	Boiler power	4.0 kW	5.0 kW	5.0 kW
	Wash pump power	0.3 kW	0.7 kW	0.7 kW
Electrical data	Power connection	400V-50Hz-3/N/PE	400V-50Hz-3/N/PE	400V-50Hz-3/N/PE
	Fuse protection	15 A	15 A	15 A
	Default connection	6.6 kW	8.4 kW	8.4 kW
	Multi-phase option	●	●	●

\* Depending on local conditions (inlet water temperature / electrical supply), the values indicated may vary.

\*\* Minimum inlet pressure RO system 1.5 bar.

\*\*\* Min - Max water connection temperature for SHR+ system models is 5°C-20°C .

	Traywasher 500×500	Hood Type 500×500	Hood Type 600×500	
Range	Undercounter	●		
	Raised	●		
	Twin Basket			
	Softener	●	●	●
	Steam Heat Recovery System (SHR+)		●	●
	Integrated Reverse Osmosis System			
General data	Basket dimensions	500x500 mm	500x500 mm	600x500/500x500 mm
	Net weight	68 Kg	115 Kg	128 Kg
	Usable load height	400 mm	470 mm	470 mm
	Tray capacity	7xGN 1/1 (530x325 mm) 6xEN (600x400 mm)	7xGN 1/1 (530x325 mm)	7xGN 1/1 (530x325 mm) 6xEN (600x400 mm)
	Rinse pump	Yes	Yes	Yes
	Drain pump	Yes	Yes	Yes
	Wash Programs	10 customisable programs	10 customisable programs	10 customisable programs
	Self-cleaning Programs	4	4	4
Technical data	Protection class	IPX4	IPX4	IPX4
	Noise	56.5 dB	59.9 dB	59.9 dB
	Maximum baskets/hour*	45	45	45
	Maximum dishes/hour*	810	810	990
	Maximum glasses/hour*	1620	1620	2520
	Wash temperature (min-max)	60-70°C	60-70°C	60-70°C
	Rinse temperature (min-max)	65-87°C	65-87°C	65-87°C
	Cold rinse temperature	-	-	-
	Tank capacity	11 L	14 L	22 L
	Minimum water consumption per cycle	1.8 L	1.8 L	1.8 L
	Inlet pressure (min-max)**	100-1000 kPa	100-1000 kPa	100-1000 kPa
	Inlet water temperature (min-max)***	5-60°C	5-60°C	5-60°C
	Tank power	2.0 kW	2.0 kW	2.0 kW
	Boiler power	5.0 kW	7.05 kW	7.05 kW
	Wash pump power	0.7 kW	0.7 kW	0.7 kW
Electrical data	Power connection	400V-50Hz-3/N/PE	400V-50Hz-3/N/PE	400V-50Hz-3/N/PE
	Fuse protection	15 A	16 A	16 A
	Default connection	8.4 kW	10.0 kW	10.0 kW
	Multi-phase option	●	●	●

\* Depending on local conditions (inlet water temperature / electrical supply), the values indicated may vary.

\*\* Minimum inlet pressure RO system 1.5 bar.

\*\*\* Min - Max water connection temperature for SHR+ system models is 5°C-20°C.

Undercounter Glasswasher 400×400

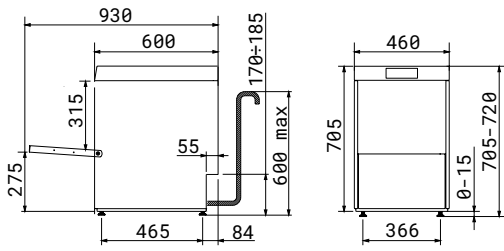

Undercounter Glasswasher 500×500

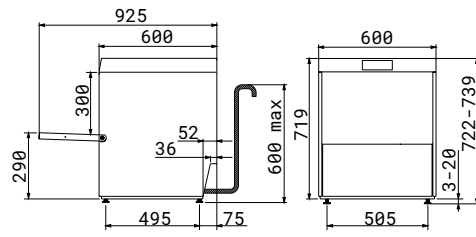

Undercounter Dishwasher 500×500

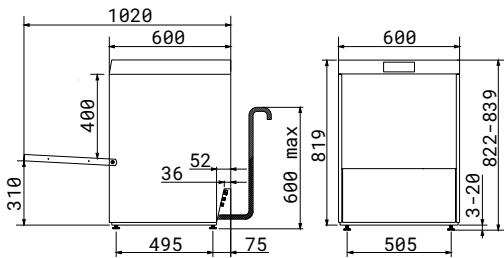

Undercounter Traywasher 500×500

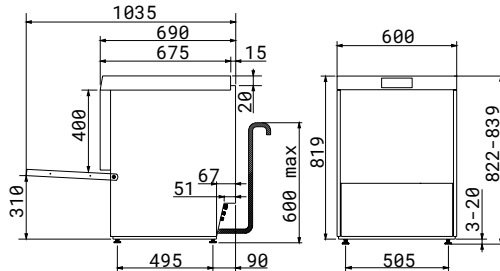

Raised Dishwasher 500×500

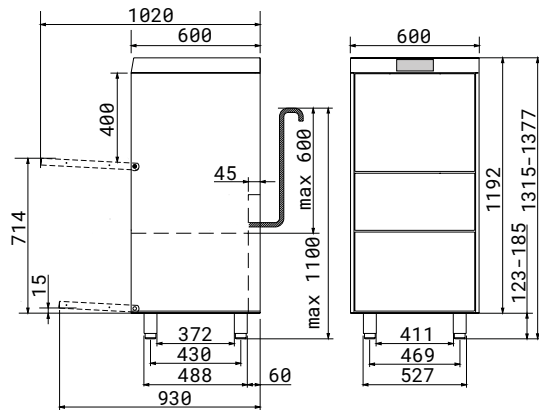

Raised Traywasher 500×500

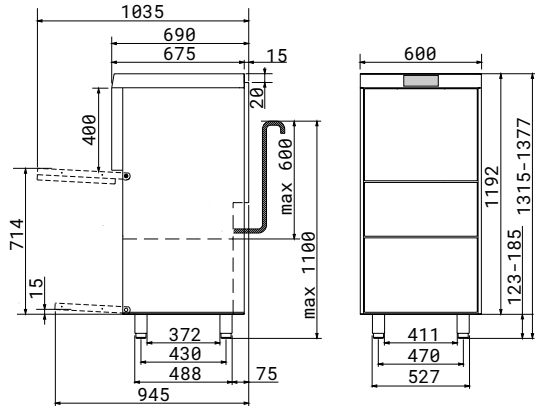

Hood Type 500×500

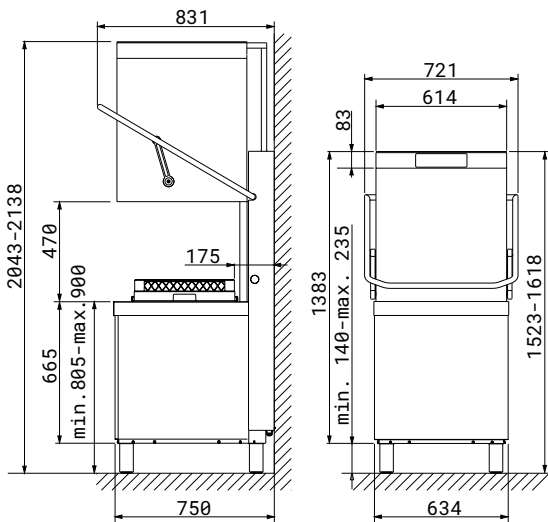

Hood Type 600×500

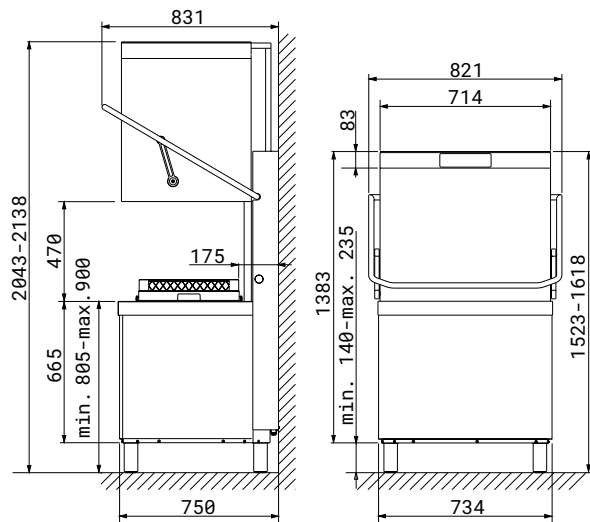



# The beauty of performance.

There is a distinct beauty in the way a Smeg Professional appliance performs, rooted in the precision of its design and engineering. Every element is crafted to function seamlessly, reflecting the harmony between form and function. The elegance of its operation lies in this perfection, where every detail is optimised to deliver efficiency, reliability, and exceptional results.